

# FOMO-COOL

## Cooler Bypass Delete Kit

4R44E, 4R55E, 5R44E, 5R55E, 5R55W, 5R55S, 5R55N, 6R140 valve bodies,  
4R70W, 6F35, 6F50, 6R60, 6R80, 62TE bypass block, 5R110W pump,  
6F35, 6R60, 6R80, 6R100 with bypass in the case.



### Corrects/Prevents/Reduces:

- Provides all-time cooler flow regardless of temperature
- Prevents overheating
- Reduces transmission fluid temperature
- Eliminates thermostatic assembly
- Allows you to accurately check fluid level immediately after install without having to wait or go through a warm-up cycle

### Kit Includes:

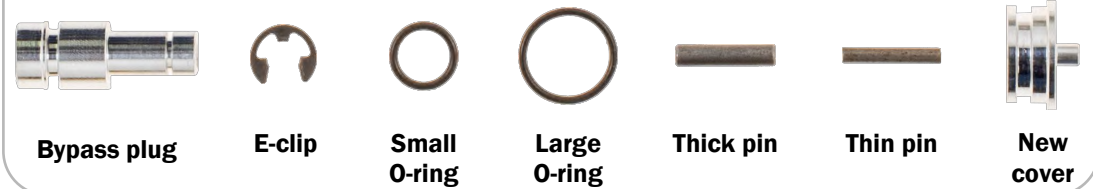

The bypass plug in this kit is used by itself or in combination with the other components provided, allowing you to eliminate the thermostat on a variety of applications.

Begin by identifying your specific application using the illustration below and on the following pages. Follow the easy disassembly and reassembly procedures outlined in the illustrations for your application using the required kit component(s).

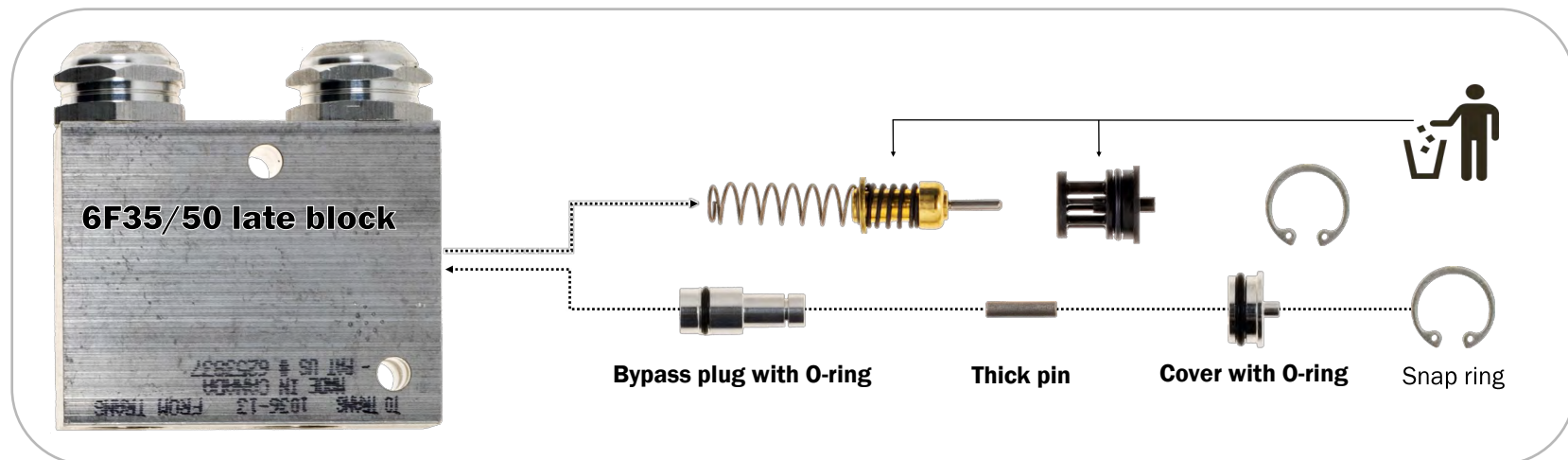

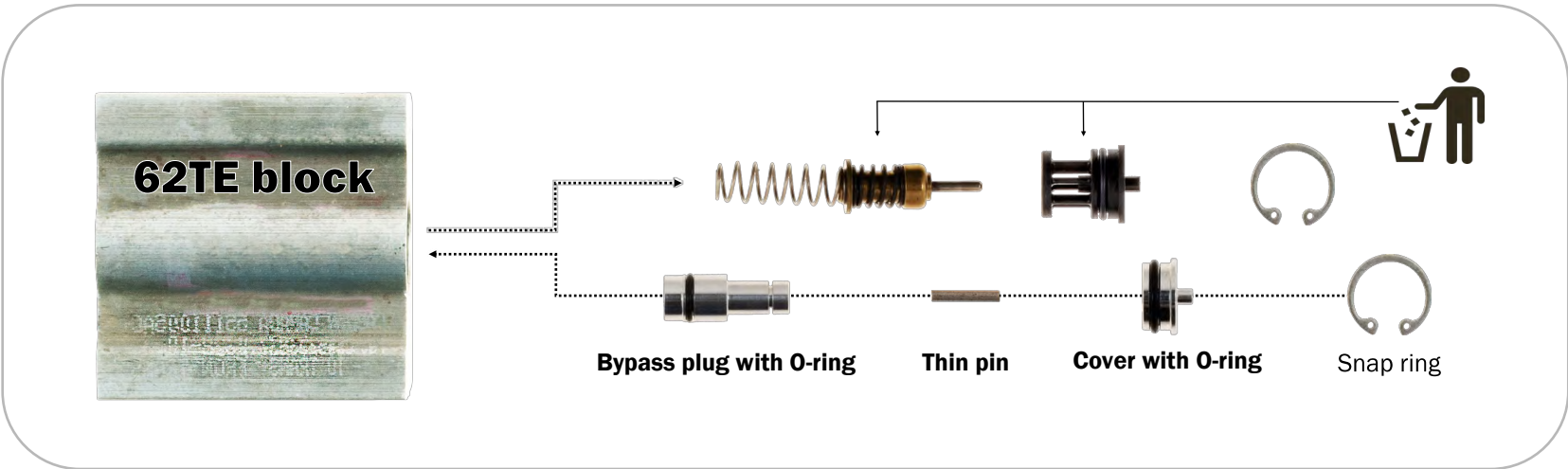
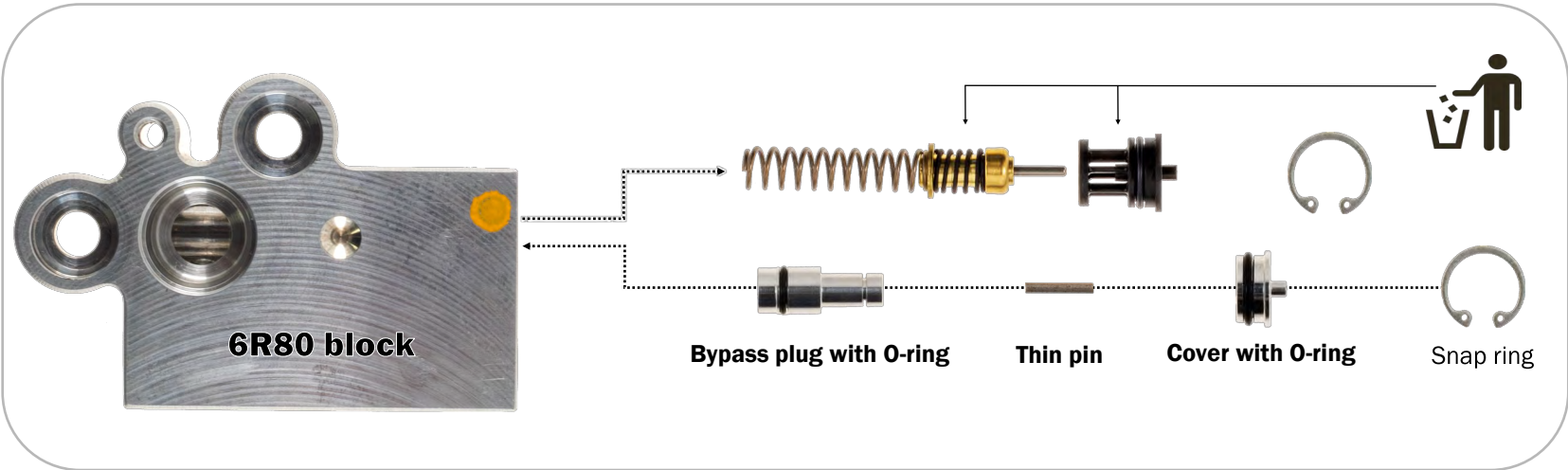
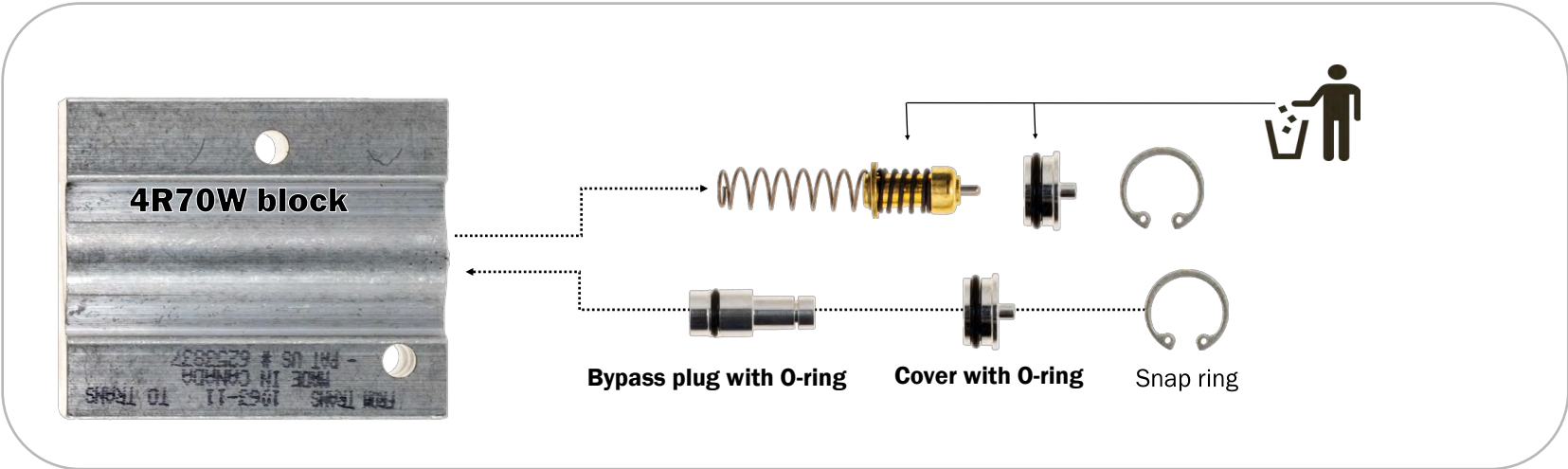

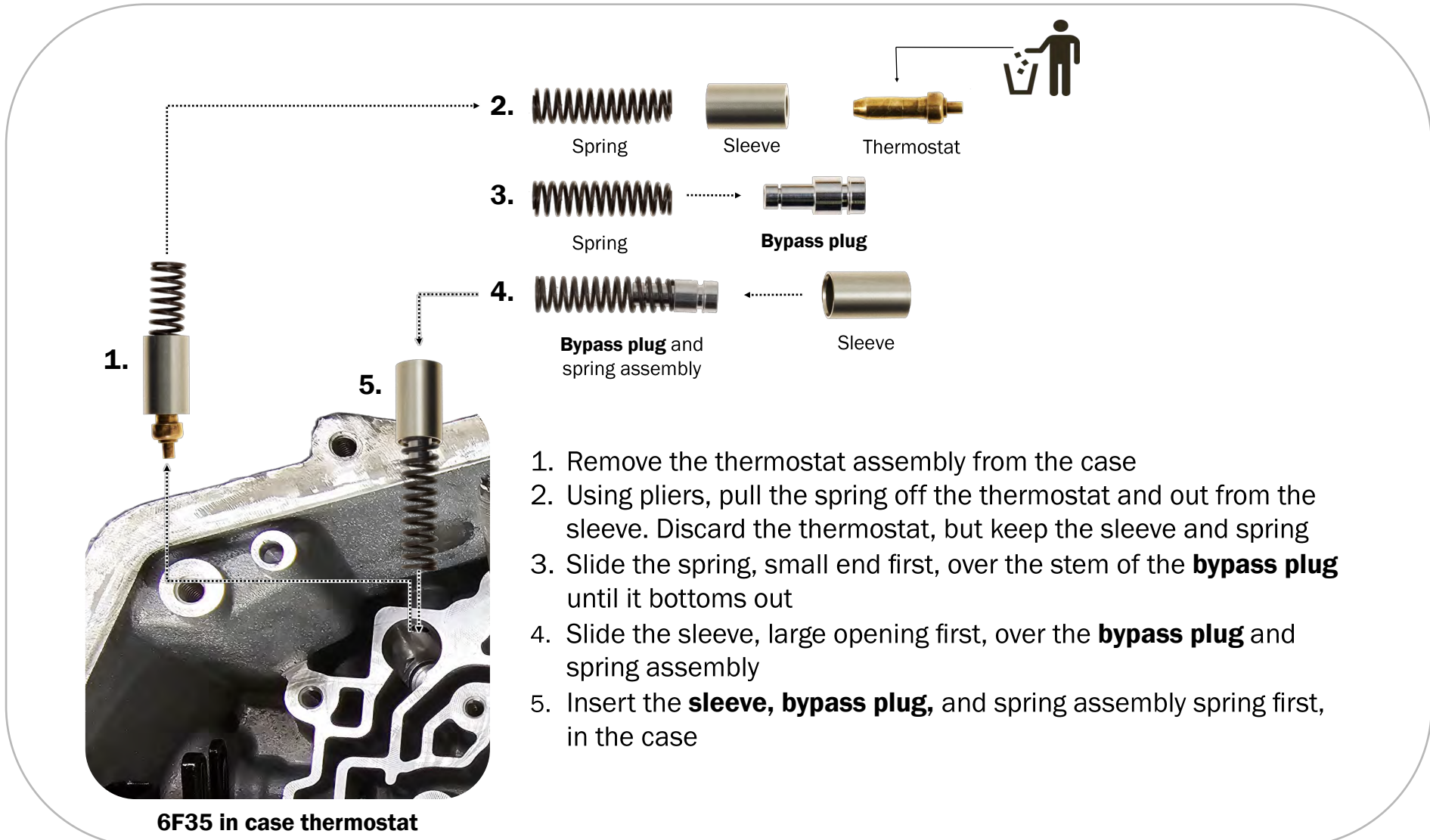
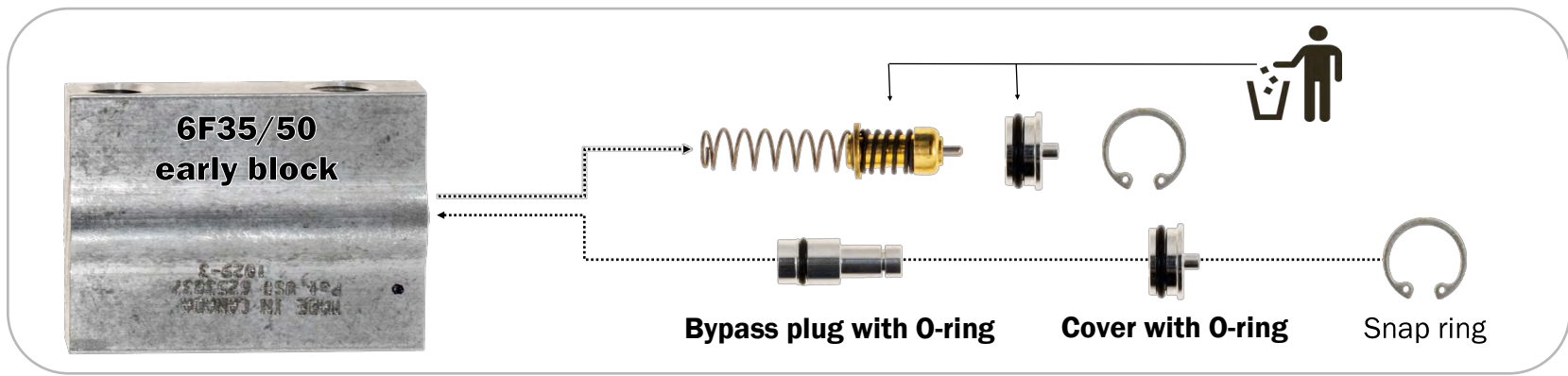

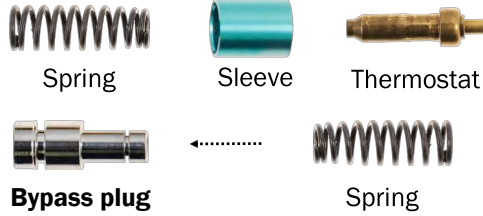
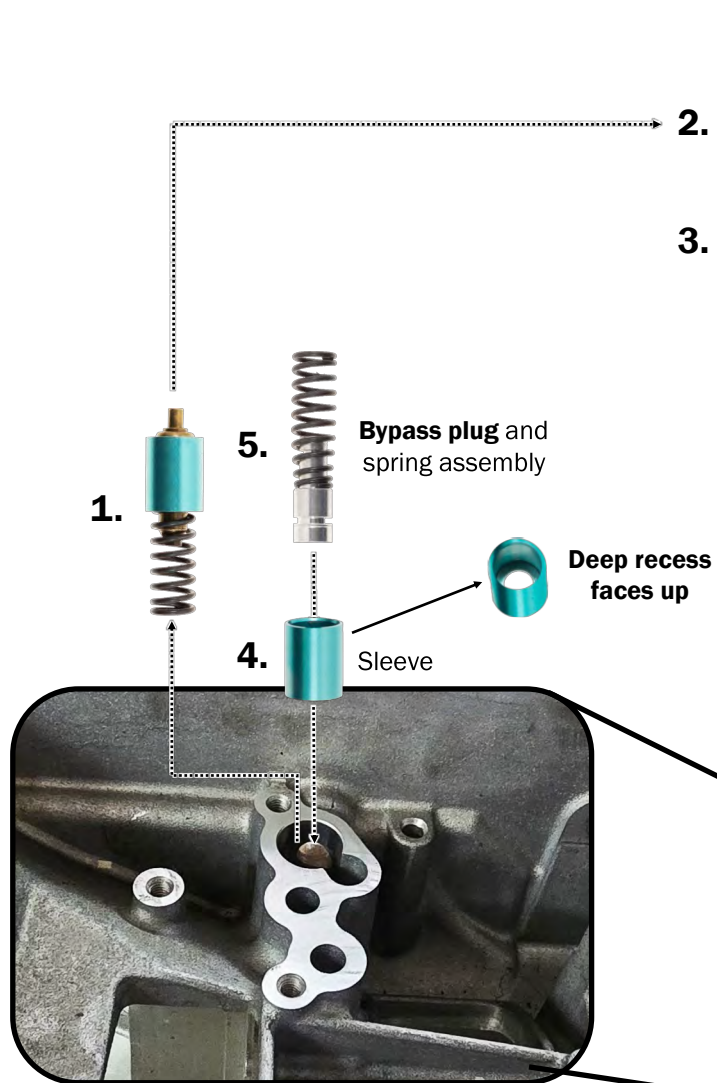

1. Remove the thermostat assembly from the case
2. Using pliers, pull the spring off the thermostat and out from the sleeve. Discard the thermostat, but keep the sleeve and spring
3. Slide the spring, small end first, over the stem of the **bypass plug** until it bottoms out
4. Insert the sleeve in the case with the **deep recess facing up**
5. Insert the **bypass plug** and spring assembly in the sleeve with the **spring facing up**

6R60/6R80/6R100 in case thermostat

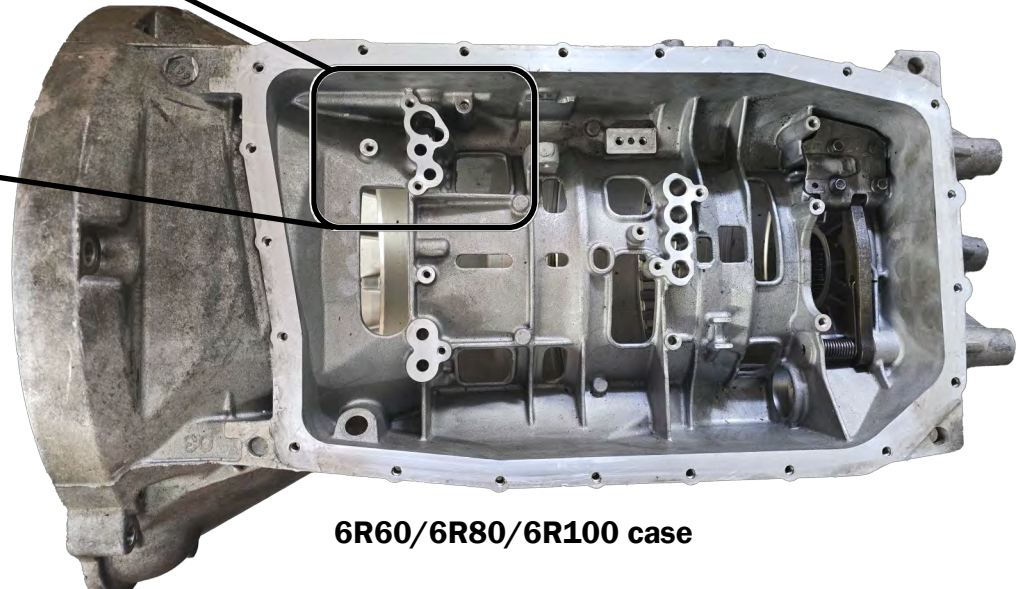

6R60/6R80/6R100 case

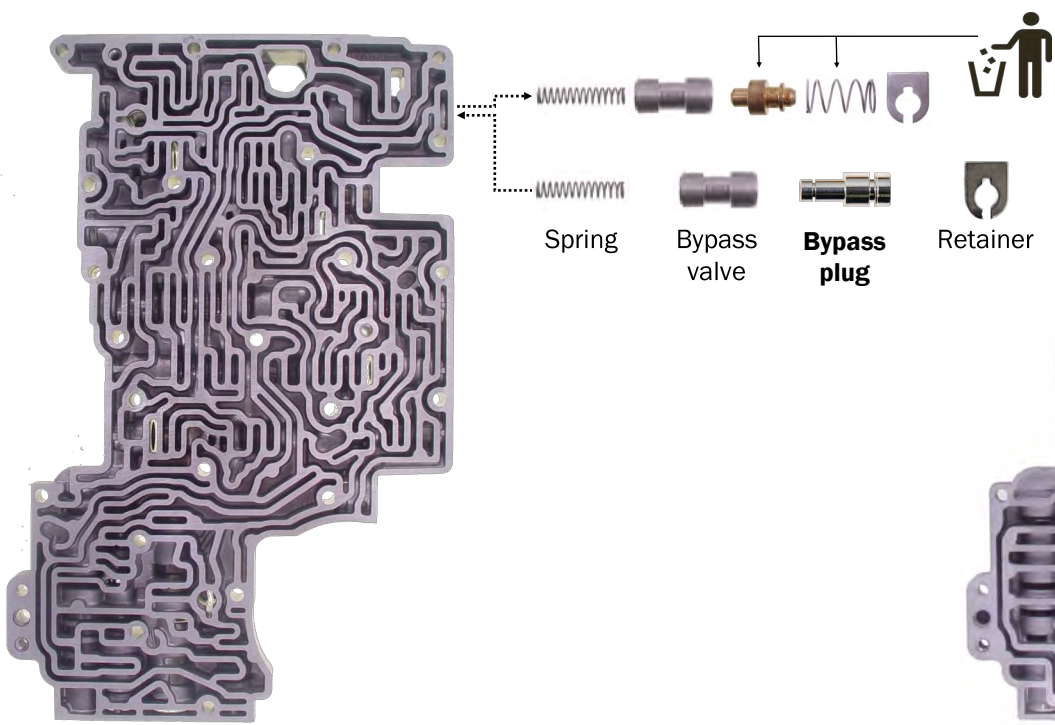

4R44E/5R44E/4R55E/5R55E valve body

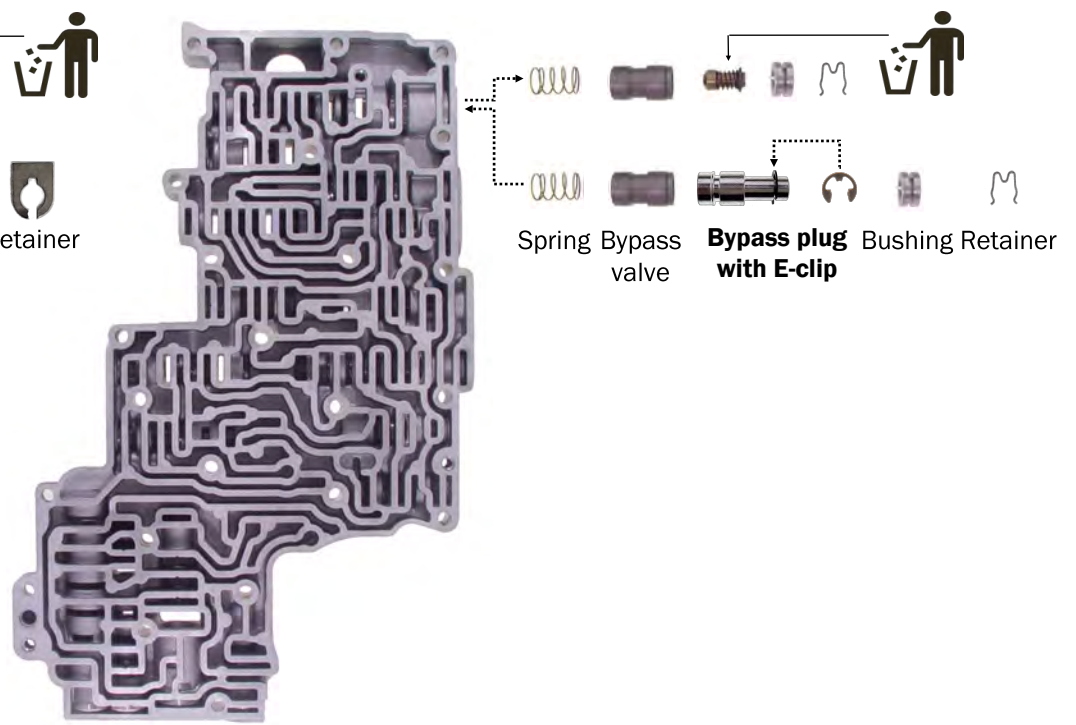

5R55N/S/W valve body

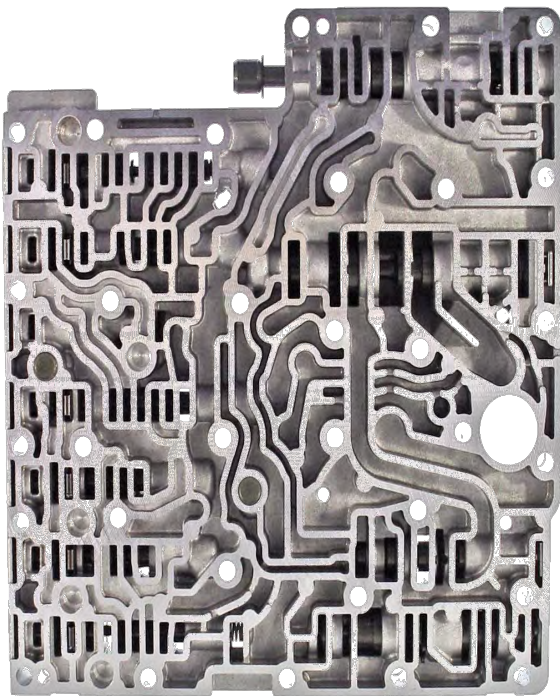

6R140 valve body

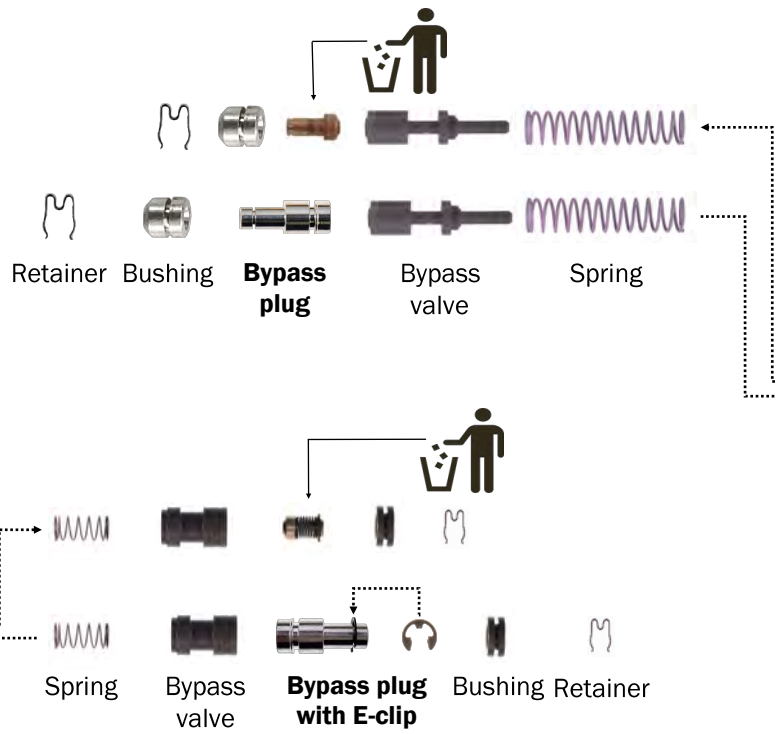

5R110W pump



# COOLER BYPASS SOLUTIONS from





**Provides all-time cooler flow regardless of temperature | Prevents overheating | Reduces ATF temperature | Eliminates thermostatic assembly | Accurately check fluid level after install without waiting**



**#FOMO-COOL**  
 Located in valve body  
 4R44E 4R55E 5R44E 5R55E  
 5R55N 5R55S 5R55W 6R140  
 Located in bypass block  
 4R70W 6F35 6F50 62TE  
 6R60 6R80  
 Located in transmission case  
 6F35 6R60 6R80 6R100  
 Located in pump  
 5R110W

**#6L80-CLR-BYPASS**  
 6L80 2014-on 6L90 2014-on 8L90 2016-on Allison 2017-19  
 An easy, no-hassle cost-effective drop-in cooler flow bypass delete kit for General Motors 6L80, 6L90, 8L90 and Allison transmissions.

**#6R80-CLR-BYPASS**  
 Located in transmission case  
 6R60 6R80  
 This bypass plug works ONLY in units that have the bypass located in the case. It was designed to be the most economical bypass method for this 6R series. The new FOMO-COOL will work whether the bypass is located in the case or in the bypass block.

**ENGINEERED FOR PERFORMANCE.  
 DESIGNED FOR DURABILITY.**

